

## Socket Cap Screws

**Stainless Steel, with Low-Profile Head, with Recessed Stud for Loss Protection**

### SPECIFICATION

Stainless steel AISI 304 NI

### INFORMATION

Socket cap screws GN 7984.2 have a low-profile head to enable use in areas with limited space.

Due to a recessed stud  $d_3$ , the screw can be easily secured against loss, for example in a cover. Thus the „captive of the mounting element“ according to the Machinery Directive 2006 / 42 / EG is given.

For this purpose, instead of a normal through / threaded hole a thread  $d_1$  on both sides, if necessary with a corresponding clearance hole  $d_4$  must be provided. Depending on the design and required clamping length  $a_1$  ...  $a_3$  of the cover, there are a number of assembly options as shown.



### TECHNICAL INFORMATION

- Stainless Steel Characteristics (see page A26)

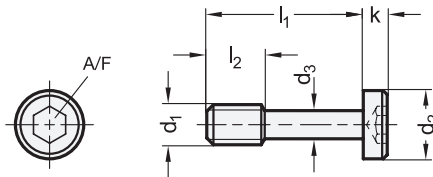

### Assembly options

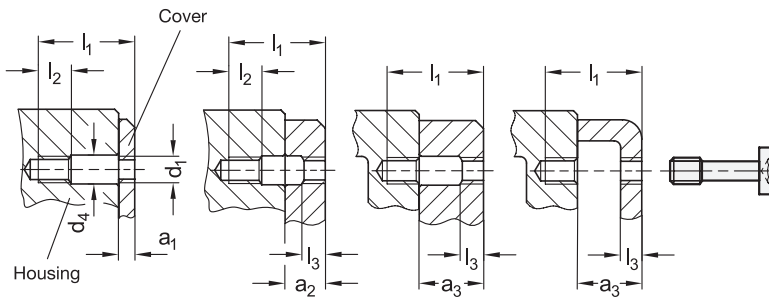

### GN 7984.2

STAINLESS STEEL

Description	d1	l1	a1	a2	a3	d2	d3-0.3	d4	k	l2	l3	A/F	△
GN 7984.2-M3-12-NI	M 3	12	1.5-3	3-6.5	6.5-8	5.5	2.2	3.5	2	4	1.5	2	1
GN 7984.2-M3-16-NI	M 3	16	3-7	7-8	8-12	5.5	2.2	3.5	2	4	1.5	2	2
GN 7984.2-M4-16-NI	M 4	16	2-5	5-8	8-11	7	3	4.5	2.8	5	2	2.5	2
GN 7984.2-M4-20-NI	M 4	20	5-9	9-11	11-15	7	3	4.5	2.8	5	2	2.5	3
GN 7984.2-M5-20-NI	M 5	20	2.5-6	6-10.5	10.5-14	8.5	3.9	5.5	3.5	6	2.5	3	3
GN 7984.2-M5-25-NI	M 5	25	6-11	11-14	14-19	8.5	3.9	5.5	3.5	6	2.5	3	4
GN 7984.2-M6-25-NI	M 6	25	3-7	7-13	13-17	10	4.5	6.5	4	8	3	4	4
GN 7984.2-M6-30-NI	M 6	30	7-12	12-17	17-22	10	4.5	6.5	4	8	3	4	6
GN 7984.2-M8-30-NI	M 8	30	4-8	8-16	16-20	13	6.3	8.5	5	10	4	5	12
GN 7984.2-M8-35-NI	M 8	35	8-13	13-20	20-25	13	6.3	8.5	5	10	4	5	13
GN 7984.2-M8-40-NI	M 8	40	13-18	18-25	25-30	13	6.3	8.5	5	10	4	5	14

